

# Apartament 2 camere - 1005, parter, tronson 1

## Str. George Ranetti, Nr. 2-8, Sector 6

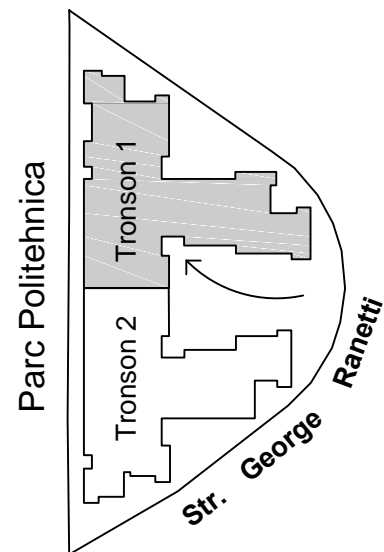
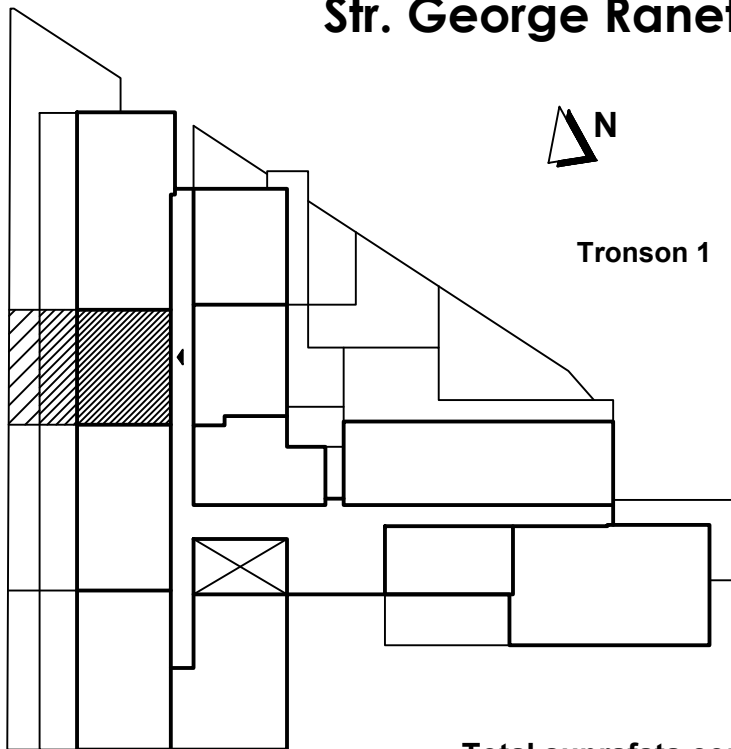

**Total suprafata construita apartament = 91.90 mp, din care:**

- suprafata construita terasa = 21.60 mp
- suprafata construita gradina = 16.80 mp

**Total suprafata utila apartament = 64.30 mp**

